

## **APPENDIX B**

- Applicant** Mr Saleem Ismail
- Location:** On the footway outside 1366-1368 London Road, Norbury SW16 4DE
- Measurements:** The measurement from the shop window to the edge of the pavement is 5.27m.  
The applicant applied for a trading area of 1.20 m but has subsequently requested to amend the width to 0.5 m.  
There is a telephone box sited 3.70 m from the shop front which leaves a clear pavement width of 2.97m from the nearest table.  
There is also 1.57m additional clearance between the telephone box and the kerb.  
London Road is maintained by TfL and the required clear pavement width is 2.8 m.
- A length of 7.60 m is also applied for.
- Appendix B1 shows a plan of the site.  
Appendices B2 and B3 are photographs of the display.

### **Proposed Times of Trading:**

Sunday to Thursday 1130 hours until 0000 hours (midnight)  
Friday & Saturday 1130 hours until 0200 hours on the days following

### **To Display:** Tables and Chairs

#### **1. Detailed Considerations**

- 1.1 The application was received by the Development & Environment Department on 2<sup>nd</sup> December 2013.  
A copy of the application is attached as Appendix B4.
- 1.2 The application was duly advertised in the Croydon Guardian, no objections were received.
- 1.3 The Police licensing Officers, Food Safety team, Planning, Highways, and parking services divisions were invited to comment on this application, no objections have been received.
- 1.4 Objections have been received from a local Councillor and a local residents association, copies of these are attached as Appendix B5.
- 1.5 The applicant was advised by letter that as this site is on London Road and in accordance with Council Policy the Committee will generally be minded to refuse any further requests for designation, due to 'additional sites would have

a detrimental impact on the safe and convenient passage of pedestrians in that part of the street', but will consider each request on its merits. A copy of the letter is attached as Appendix B6

- 1.6 The measurements outlined above have been checked and agreed by an Enforcement Officer during a site visit.
- 1.7 A temporary licence was issued to the applicant which is valid until the 2.6.2014 pending the Committee's decision. A copy is attached as Appendix B7.
- 1.8 There are 5 other nearby premises in London Road who currently hold street trading licences: No's 1350 – household goods, 1356a – flowers and plants, 1392 – tables and chairs, 1437 –fruit and vegetables, 1439 – fruit and vegetables.

The position of these sites are marked with a \* and the site applied for is shaded on the attached map Appendix B8.

- 1.9 If the application for a street designation order is granted the applicant will be invited to apply for a Street Trading Licence which will then be valid for a year

B1



372

Bike  
Rack  
Post

Phone  
Box.

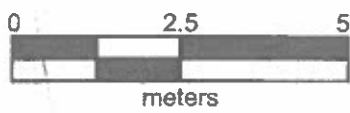
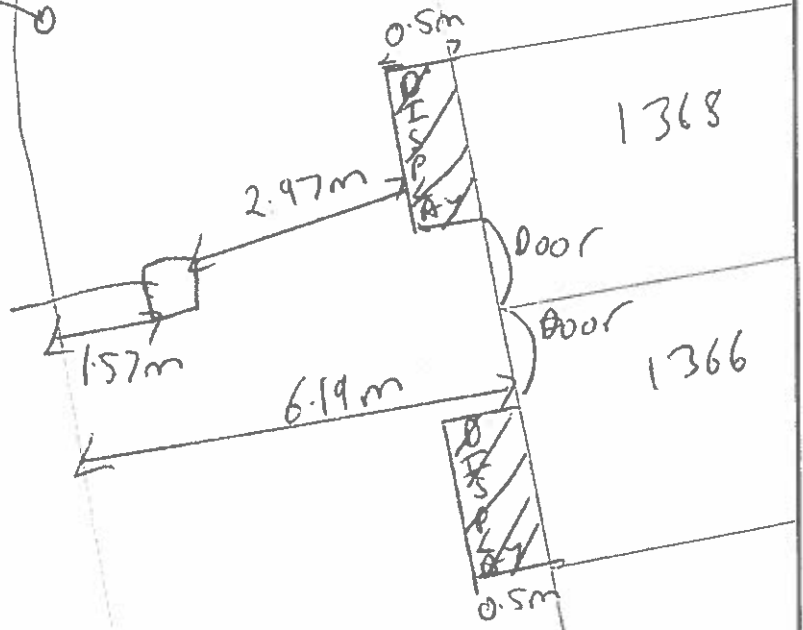

© London Borough of Croydon  
(Licence No. 100019257) 2013

**CROYDON**  
www.croydon.gov.uk

Crown Copyright Ordnance Survey (License No: 100019257) 2011

**1366-1368 London Road**



Scale 1:105

14-Dec-2013



B2



133

34

**CROYDON**

www.croydon.gov.uk

**STREET TRADING LICENSING**

**APPLICATION FOR A STREET DESIGNATION ORDER**

Return completed form to: Licensing Team, Planning & Environment Department, Croydon Council, 10<sup>th</sup> Floor, Zone B, Bernard Weatherill House, 8 Mint Walk, Croydon CR0 1EA  
Telephone: 020 8760 5466

**PLEASE READ THE GUIDANCE NOTES ATTACHED BEFORE COMPLETING THIS FORM**

**1. APPLICANT (see note A)**

- a) First Name SULEM ~~SALEEM~~
- b) Last/Family Name KHALIL
- c) Full Home Address of Applicant [REDACTED]
- d) Home Tel No [REDACTED] e) Mobile No [REDACTED]
- f) E mail address: [REDACTED]
- g) Date of Birth [REDACTED] h) Passport No [REDACTED]
- i) National Insurance No [REDACTED] j) Nationality: [REDACTED]

**2. SITE TO BE DESIGNATED (see Note B) For Mobile Vehicles/Trailers go to section 4**

- a) Trading Name of Premises: ADAM'S SPORTS
- b) Trading Address: 1366/1368 LONDON Rd  
HARBURY, LONDON SW16 4DE
- c) Business Tel No: 0207 998 4747

**3. DISPLAY AREA (see note C)**

- a) Dimensions of display area (state whether measured in feet or metres) Receipt 167735  
Length 7.6m Width 1.2m Height 1.0m

Environmental, Cultural and Sports Services Department  
Dec  
FOR ATTN: CS

34

b) Hours that you would like to display the goods/services on the highway.

Sunday: from 11:30 to 00:00 Thursday: from 11:30 to 00:00

Monday: from 11:30 to 00:00 Friday: from 11:30 to 02:00 am

Tuesday: from 11:30 to 00:00 Saturday: from 11:30 to 02:00 am

Wednesday: from 11:30 to 00:00

c) Type of goods or services to be displayed: Tables & Chairs

4. MOBILE VEHICLE/TRAILER (See note D)

a) Address of proposed pitch

b) Approx dimensions of vehicle/trailer (state whether measured in feet or metres)

Length Width Height

c) Registration No

d) Proposed hours and days of trading:

If you propose to sell hot food and drink after 2300 hours then you will require a premises licence under the Licensing Act 2003. ( see note D)

Office Use only Premises Licence No

I declare that all the information given on this form is accurate to the best of my knowledge.

I enclose a fee of £ 356

Please make cheques payable to Croydon Council

Signature of applicant(s) or applicant's Solicitor or other duly authorised agent:

*Stoney*

Date 25/11/13

If you require any assistance with the completion of this form please contact the Licensing Team on 0208 760 5466

Office Use Only Uniform No: 13/61092/ST

Receipt No: 167785 Date received: 2/12/13

B5

**From:** Mansell, Maggie  
**Sent:** 19 December 2013 09:58  
**To:** LICENSING  
**Cc:** [REDACTED]; Khan, Shafi; Chowdhury, Sherwan; [REDACTED]  
**Subject:** Licensing Applications Week 49/13 Norbury,

**3/49 - Halla Walla, 1366 - 1368 London Road, Norbury  
Request to display tables and chairs.**

Licenses have been given to various premises along the London Road in Norbury. It is helpful that a white line has been painted to show the limits of these licenses. However the line is the same distance from the wall at every point. It does not take account of the variation in width of the pavement, nor street furniture and crowd behaviour. There are various pinch points such as near pedestrian crossings and bus stops where the line should be nearer to the wall to allow free passage of people with baby buggies and shopping trolleys and scooters for people with disabilities.

This cafe is at a point where there is a phone booth on the kerb side. Therefore I object to the chairs and tables, but if the committee is minded to allow the request, please could the width be restricted to a table and two chairs, not the same width as the general line.

Maggie Mansell  
Norbury cllr



B5

**From:** [REDACTED]  
**Sent:** 18 December 2013 11:54  
**To:** LICENSING  
**Cc:** Mansell, Maggie  
**Subject:** Re: Licensing Applications Week 49/13 Norbury, Fairfield, Addiscombe& Woodside

Dear Licensing, Croydon Council

Norbury Green Residents' Association wish to object to the following Licensing Applications in Norbury:

3/49 - Halla Walla, 1366 - 1368 London Road, Norbury

Request to display tables and chairs.

This premises has, since they opened had a number of chairs and tables outside their shop. Back in August, and again in November 2013, Fiona Woodcock from Croydon Council, informed Halla Walla that they needed a licence to have the tables & chairs outside, and also told them to reduce the area that they were taking on the pavement to within the designated space.

On many occasions I have passed this shop, especially in the evening and there have been a large number of people congregating outside. The shop is located opposite a telephone box and together with the tables and chairs and customers outside causes a restriction on the public pavement. We therefore object to this license.

[REDACTED]  
Chair, NGRA

B6

Planning & Environment Department  
Licensing – Commercial Team  
9<sup>th</sup> Floor Taberner House  
Park Lane  
Croydon CR9 3JS

Tel/Typetalk: 0208 726 6000 x 62457

Fax: 020 8760 5786

Minicom: 020 8760 5797

Email: wendy.shepherd@croydon.gov.uk  
Please ask for/reply to: Wendy Shepherd

Mr Saleem Ismail  
Halla Wajah  
1366/1368 London Road  
Norbury  
SW16 4DE

Your Ref:  
Our Ref:  
Date: 24.6.2012

Dear Mr Ismail

**Subject: Street Designation Order**  
**Address: 1366/1368 London Road SW16 4DE**

I acknowledge receipt of your recent application for a street designation order and temporary licence to display goods on the highway at the above premises.

Your attention is drawn to the Council's Street Trading Policy which states:-

***'In relation to the parts of the streets listed below the Council, having consulted with the officers responsible for food safety, planning, parking, street scene and district centre managers, the Highway Authority, Transport for London, Police and licence holders in those streets or trade bodies representing them, are of the view that there are enough existing designated sites. This is on the basis that any addition to the number of existing designated sites would have an overall detrimental impact on the safe and convenient passage of pedestrians in that part of the street. The Committee will therefore generally be minded to refuse any further requests for designation but will consider each request on its merits.***

***- Entire length of London Rd***

***-Entire length of High St Thornton Heath***

***Where the Licensing Committee considers that, in any other parts of streets in the borough, there are enough existing designated sites it may, subject to a similar process of consultation, decide to include these additional parts of streets with those listed above. Similarly the Licensing Committee may from time to time determine that due to a change in circumstances parts of streets may be removed from that list. '***

Your application will be heard by the Licensing Committee at a meeting to be arranged and as your application falls within the specified area outlined in the policy, the committee will be minded to refuse the application. You should therefore attend the meeting to explain to the committee the particular reasons why you consider that your application should be granted.

**Please note that all fees paid are non refundable should the application be refused**

Yours sincerely

Mrs Wendy Shepherd  
Safety/Licensing Officer

B7

**CROYDON**  
www.croydon.gov.uk

**TEMPORARY LICENCE -  
STREET TRADING**

The Council of the London Borough of Croydon being the Local Authority for the purposes of the London Local Authorities Act 1990

**HEREBY LICENCE  
TO USE SITE KNOWN AS**

Mr Saleem Ismail  
Halla Wallah  
1366 - 1368 London Road  
London  
SW16 4DE

**TO DISPLAY  
SIZE OF DESIGNATED DISPLAY  
PERMITTED DAYS & TIMES**

Tables and Chairs  
Length 7.6 m ,Width 0.5 m.  
Sunday to Friday 1130 hours until 0000 hours  
(midnight)  
Saturday & Sunday 1130 hours until 0200 hours.

**Please note that the person named on the licence and whose photograph appears on the licence is responsible for the premises at all times. This licence may not be transferred to any other person.**

**Date Licence Valid From: 02.12.2013**

**Date Licence Expires: 02.06.2014**

**Licence Number: 13/01092/STT**

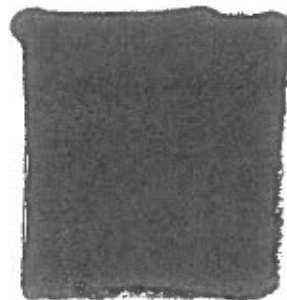

**Trading standards and Licensing Manager  
Planning & Environment Department**

Special Conditions

Transport for London Maintained Roads

1. The licensee shall ensure that there is a minimum clear passage of **2.8 metres** between the front edge of their display and the edge of the kerb or any item of street furniture (railings/lamp post etc) – whichever is the nearer to the display.
2. A clear copy of the licence shall be displayed in the front window of the premises at all times and should be visible to passers – by.
3. Please note that the person named on the licence and whose photograph appears on the licence is responsible for the premises at all times.  
This licence may not be transferred to any other person.
4. The right to trade from the designated site will be temporarily suspended when Utility Companies or the Highway Authority require access to the footway to carry out necessary works, until the completion of those works.
5. The limits of the designated area may be marked on the footway/roadway by the Council to enable verification by Council & Highway Officers.
6. Premises displaying tables and chairs shall enclose the display area with a suitable barrier material e.g. rope.
7. The licence holder is responsible for removing all litter from the licensed area and adjacent footway at regular intervals during the day and at the close of business each day.

08

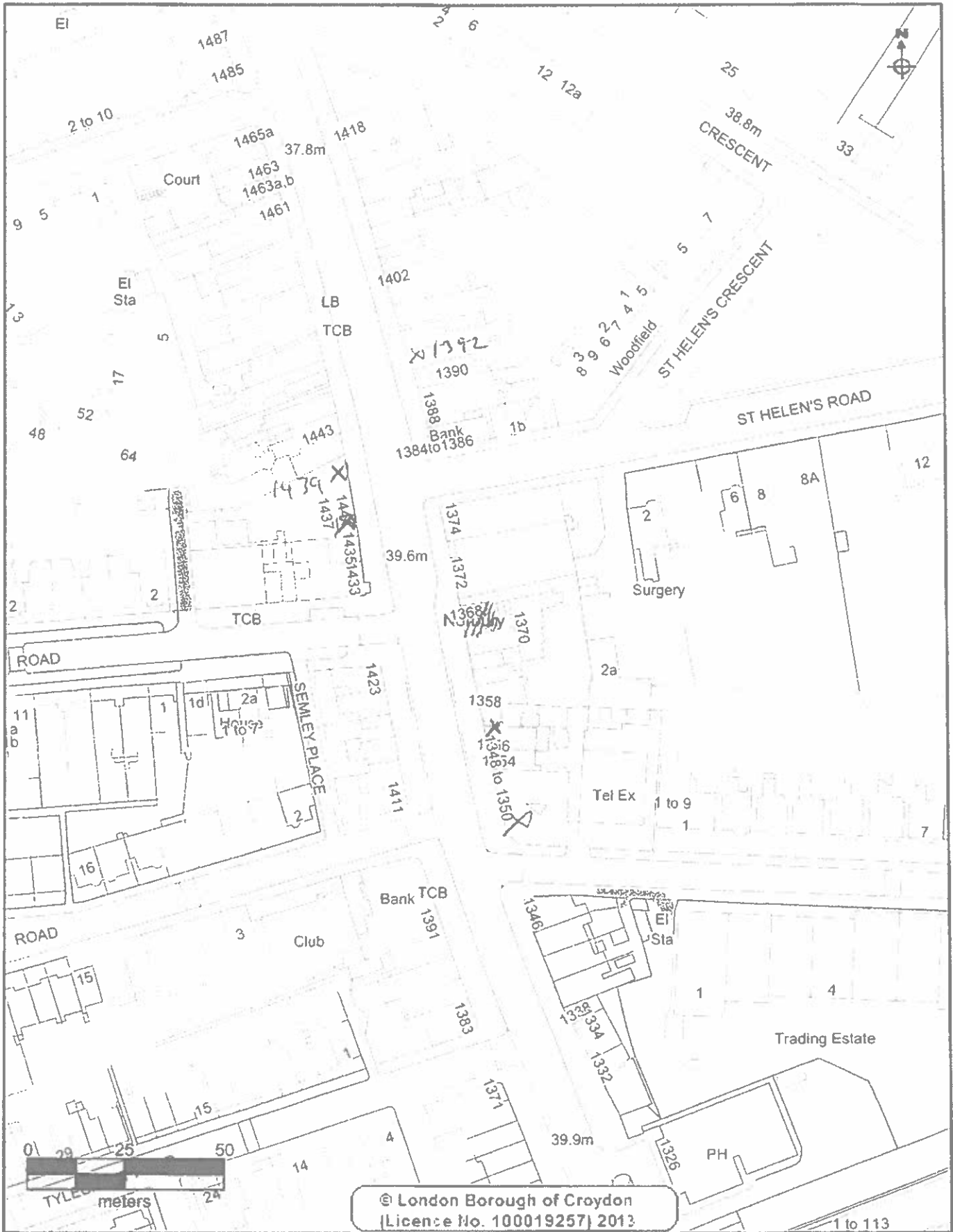

**CROYDON**  
www.croydon.gov.uk

Crown Copyright Ordnance Survey (License No: 100019257) 2011

**1366-1368 London Road**



Scale 1:1250

14-Dec-2013